

| Document Version Control | | |
|--------------------------|----------------|--------------|
| Document Number | Version Number | Release Date |
| AP0006 | 1 | 22/05/2017 |

LOCKJAW LIP SHROUD INSPECTION AND REMOVAL GUIDE

SAFETY NOTICE

Working on heavy equipment is dangerous. Please ensure you have considered your workplace safe work procedures and the following key points before commencing any assembly or installation procedures.

- Wear correct PPE including:
 - Full length clothing and work gloves
 - Safety work boots
 - Safety glasses
 - Hearing protection
- Good general housekeeping to ensure the work area is safe and free of clutter.
- Use appropriate lifting apparatus to lift heavy items. Please refer to your work place procedures. Lifting points are provided and weights specified on all parts.
- Ensure appropriate tags for your work place and work environment are used.

PLEASE NOTE: THIS PROCEDURE WILL REVIEW THE INSPECTION OF LOCKS AND WEAR INDICATORS AND PROVIDE A BASIC REMOVAL GUIDE FOR LOCKJAW SHROUDS



Lock indication marker should be assessed each time the loader is inspected or at the start of each shift to establish that the lock is in the "safe zone" within the cavity. If the lock is within the safe zone it cannot come off in operation.

Daily or shift inspection chart – mark lock position

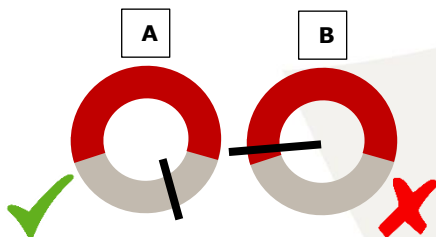
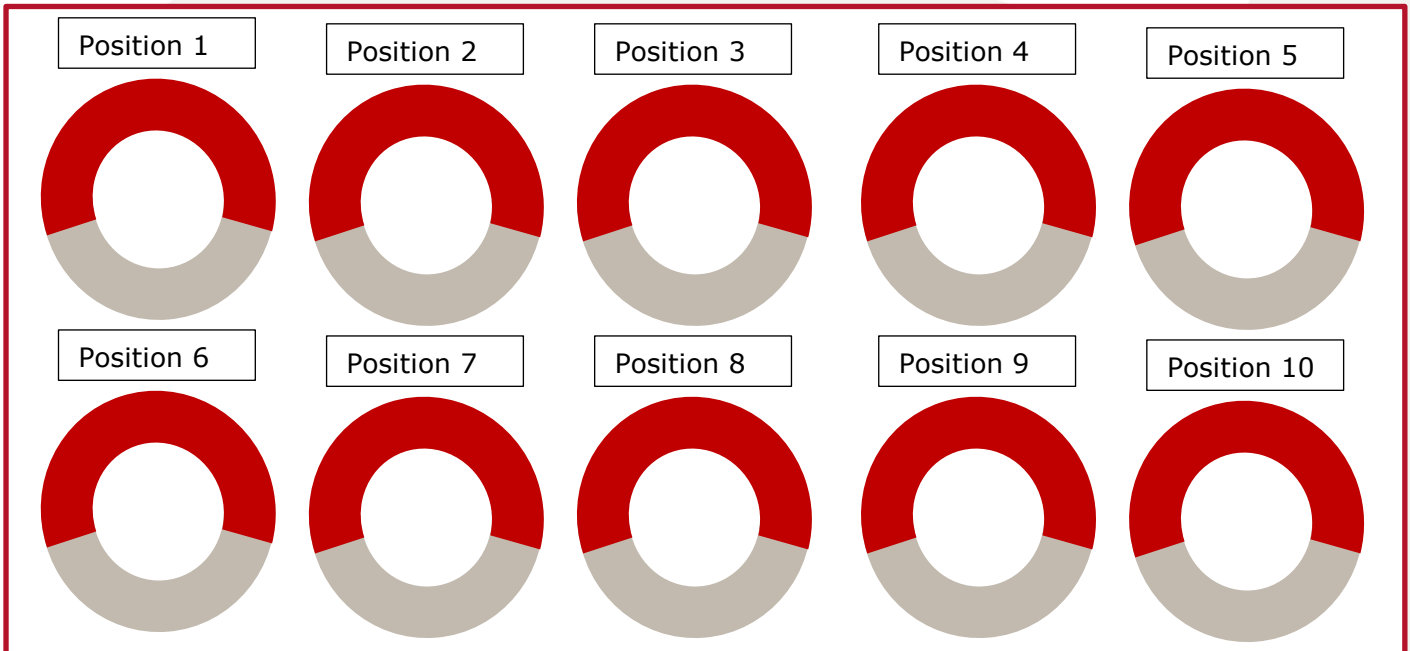

Example "A" indicates that the lock is in a good position and no maintenance is required for the shroud.

Example "B" indicates that the lock is getting toward the end of the safe zone. **Insert (LJI-H)** in boss or cast corner should be changed returning the lock position toward the six o'clock mark of better.

| Document Version Control | | |
|--------------------------|----------------|-------------------|
| Document Number | Version Number | Release Date |
| AP0006 | 1 | 22/05/2017 |

Lockjaw Basic Removal Instructions



Worn Corner

Wear Indicator Location

Lockjaw wear indicators will break through bottom of the shrouds. Corners should be inspected from underneath as they will not always break through on the side (as per other products in the market). Once wear indicators are visible it is advisable to change worn shrouds at next opportunity to reduce the risk of shrouds peeling off during operation.

Shrouds and Lip should be well washed with pressure washer to remove any material in and around the lock cavities and boss area for ease of removal.

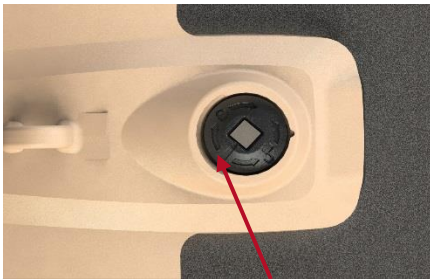

Figure 1 – Lock in Safe Zone prior to removal



Figure 2 – Rotate lock back to neutral position

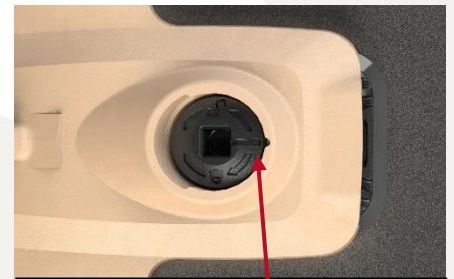

Figure 3 – Lock in neutral position

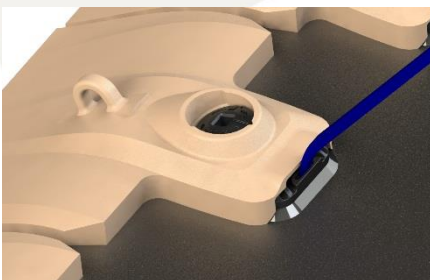

Figure 4 – insert pry bar into boss washout grooves and pry shroud forward



Figure 5 – Move pry bar to next grooves and continue until shroud is removed



Figure 6 – Check Insert **DO NOT** lose during removal process

Once shrouds are removed lip and bosses should be washed and prepared for installation of new shrouds – refer Talon Doc AP0002 Lockjaw Lip Shroud Installation. For information regarding the Talon Inserts Doc AP0008 Inserts Guide and Instructions